

## BOSCH Common Rail

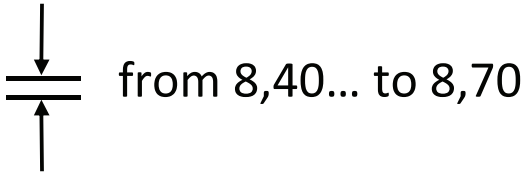

CYL. POINTER



Other measures supplied on demand

Code	shim	increase	pcs.
AZ0019-13CR	from 8,4 to 8,5	0,01	110
AZ0019-22CR	from 8,5 to 8,7	0,01	210
AZ0019-41CR	from 8,4 to 8,7	0,01	310



12/24/50 positions box

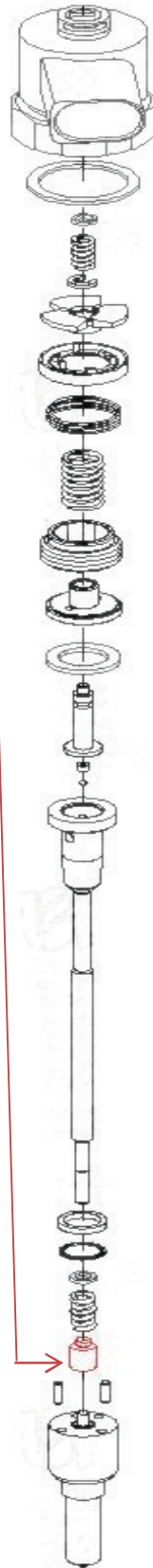

specific shim code	
thickness	code
8,40	11-23-227/840
8,41	11-23-227/841
8,42	11-23-227/842
8,43	11-23-227/843
8,44	11-23-227/844
8,45	11-23-227/845
8,46	11-23-227/846
8,47	11-23-227/847
8,48	11-23-227/848
8,49	11-23-227/849
8,50	11-23-227/850
8,51	11-23-227/851
8,52	11-23-227/852
8,53	11-23-227/853
8,54	11-23-227/854
8,55	11-23-227/855
8,56	11-23-227/856
8,57	11-23-227/857
8,58	11-23-227/858
8,59	11-23-227/859
8,60	11-23-227/860
8,61	11-23-227/861
8,62	11-23-227/862
8,63	11-23-227/863
8,64	11-23-227/864
8,65	11-23-227/865
8,66	11-23-227/866
8,67	11-23-227/867
8,68	11-23-227/868
8,69	11-23-227/869
8,70	11-23-227/870

**BOSCH Common Rail**

CYL. POINTER

Original codes table

 $\begin{array}{c} \downarrow \\ \hline \uparrow \end{array}$  increase 0,012

thickness	original code	code
8,277	F 00V C12 400	11-23-227/8277
8,289	F 00V C12 404	11-23-227/8289
8,301	F 00V C12 408	11-23-227/8301
8,313	F 00V C12 412	11-23-227/8313
8,325	F 00V C12 416	11-23-227/8325
8,337	F 00V C12 420	11-23-227/8337
8,349	F 00V C12 424	11-23-227/8349
8,361	F 00V C12 428	11-23-227/8361
8,373	F 00V C12 432	11-23-227/8373
8,385	F 00V C12 436	11-23-227/8385
8,397	F 00V C12 440	11-23-227/8397
8,409	F 00V C12 444	11-23-227/8409
8,421	F 00V C12 448	11-23-227/8421
8,433	F 00V C12 452	11-23-227/8433
8,445	F 00V C12 456	11-23-227/8445
8,457	F 00V C12 460	11-23-227/8457
8,469	F 00V C12 464	11-23-227/8469
8,481	F 00V C12 468	11-23-227/8481
8,493	F 00V C12 472	11-23-227/8493
8,505	F 00V C12 476	11-23-227/8505
8,517	F 00V C12 480	11-23-227/8517
8,529	F 00V C12 484	11-23-227/8529
8,541	F 00V C12 488	11-23-227/8541
8,553	F 00V C12 492	11-23-227/8553
8,565	F 00V C12 496	11-23-227/8565
8,571	F 00V C12 498	11-23-227/8571