

BOSCH Common Rail

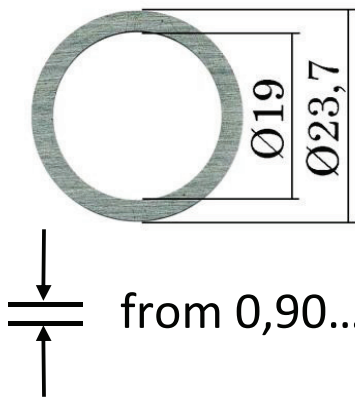

from 0,90... to 1,20

code	shim	increase	pcs.
AZ0019-18 CR	from 0,90 to 1,0	0,01	110
AZ0019-11CR	from 1,00 to 1,1	0,01	110
AZ0019-39 CR	from 1,10 to 1,2	0,01	110



12 positions box



96 positions box

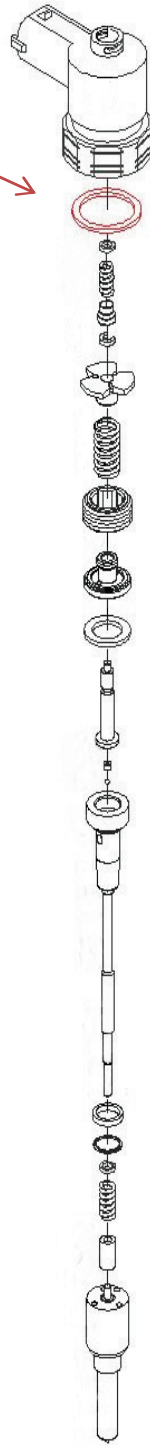

specific shim code	
thickness	code
0,90	11-23-236/090
0,91	11-23-236/091
0,92	11-23-236/092
0,93	11-23-236/093
0,94	11-23-236/094
0,95	11-23-236/095
0,96	11-23-236/096
0,97	11-23-236/097
0,98	11-23-236/098
0,99	11-23-236/099
1,00	11-23-236/100
1,01	11-23-236/101
1,02	11-23-236/102
1,03	11-23-236/103
1,04	11-23-236/104
1,05	11-23-236/105
1,06	11-23-236/106
1,07	11-23-236/107
1,08	11-23-236/108
1,09	11-23-236/109
1,10	11-23-236/110
1,11	11-23-236/111
1,12	11-23-236/112
1,13	11-23-236/113
1,14	11-23-236/114
1,15	11-23-236/115
1,16	11-23-236/116
1,17	11-23-236/117
1,18	11-23-236/118
1,19	11-23-236/119
1,20	11-23-236/120

BOSCH Common Rail

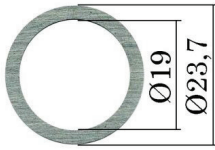

Original codes table

↕ increase 0,004

thickness	original code	code
0,86	F 00V C60 175	11-23-236/086
0,864	F 00V C60 177	11-23-236/0864
0,868	F 00V C60 179	11-23-236/0868
0,872	F 00V C60 181	11-23-236/0872
0,876	F 00V C60 183	11-23-236/0876
0,88	F 00V C60 185	11-23-236/088
0,884	F 00V C60 187	11-23-236/0884
0,888	F 00V C60 189	11-23-236/0888
0,892	F 00V C60 191	11-23-236/0892
0,896	F 00V C60 193	11-23-236/0896
0,90	F 00V C60 195	11-23-236/090
0,904	F 00V C60 197	11-23-236/0904
0,908	F 00V C60 199	11-23-236/0908
0,912	F 00V C60 201	11-23-236/0912
0,916	F 00V C60 203	11-23-236/0916
0,92	F 00V C60 205	11-23-236/092
0,924	F 00V C60 207	11-23-236/0924
0,928	F 00V C60 209	11-23-236/0928
0,932	F 00V C60 211	11-23-236/0932
0,936	F 00V C60 213	11-23-236/0936
0,94	F 00V C60 215	11-23-236/094
0,944	F 00V C60 217	11-23-236/0944
0,948	F 00V C60 219	11-23-236/0948
0,952	F 00V C60 221	11-23-236/0952
0,956	F 00V C60 223	11-23-236/0956
0,96	F 00V C60 225	11-23-236/096
0,964	F 00V C60 227	11-23-236/0964
0,968	F 00V C60 229	11-23-236/0968
0,972	F 00V C60 231	11-23-236/0972
0,976	F 00V C60 233	11-23-236/0976
0,98	F 00V C60 235	11-23-236/098
0,984	F 00V C60 237	11-23-236/0984
0,988	F 00V C60 239	11-23-236/0988
0,992	F 00V C60 241	11-23-236/0992
0,996	F 00V C60 243	11-23-236/0996
1,00	F 00V C60 245	11-23-236/100
1,004	F 00V C60 247	11-23-236/1004
1,008	F 00V C60 249	11-23-236/1008
1,012	F 00V C60 251	11-23-236/1012
1,016	F 00V C60 253	11-23-236/1016
1,02	F 00V C60 255	11-23-236/102
1,024	F 00V C60 257	11-23-236/1024
1,028	F 00V C60 259	11-23-236/1028
1,032	F 00V C60 261	11-23-236/1032
1,036	F 00V C60 263	11-23-236/1036
1,04	F 00V C60 265	11-23-236/104
1,044	F 00V C60 267	11-23-236/1044
1,048	F 00V C60 269	11-23-236/1048

thickness	original code	code
1,052	F 00V C60 271	11-23-236/1052
1,056	F 00V C60 273	11-23-236/1056
1,06	F 00V C60 275	11-23-236/106
1,064	F 00V C60 277	11-23-236/1064
1,068	F 00V C60 279	11-23-236/1068
1,072	F 00V C60 281	11-23-236/1072
1,076	F 00V C60 283	11-23-236/1076
1,08	F 00V C60 285	11-23-236/108
1,084	F 00V C60 287	11-23-236/1084
1,088	F 00V C60 289	11-23-236/1088
1,092	F 00V C60 291	11-23-236/1092
1,096	F 00V C60 293	11-23-236/1096
1,10	F 00V C60 295	11-23-236/110
1,104	F 00V C60 297	11-23-236/1104
1,108	F 00V C60 299	11-23-236/1108
1,112	F 00V C60 301	11-23-236/1112
1,116	F 00V C60 303	11-23-236/1116
1,12	F 00V C60 305	11-23-236/112
1,124	F 00V C60 307	11-23-236/1124
1,128	F 00V C60 309	11-23-236/1128
1,132	F 00V C60 311	11-23-236/1132
1,136	F 00V C60 313	11-23-236/1136
1,14	F 00V C60 315	11-23-236/114
1,144	F 00V C60 317	11-23-236/1144
1,148	F 00V C60 319	11-23-236/1148
1,152	F 00V C60 321	11-23-236/1152
1,156	F 00V C60 323	11-23-236/1156
1,16	F 00V C60 325	11-23-236/116
1,164	F 00V C60 327	11-23-236/1164
1,168	F 00V C60 329	11-23-236/1168
1,172	F 00V C60 331	11-23-236/1172
1,176	F 00V C60 333	11-23-236/1176
1,18	F 00V C60 335	11-23-236/118
1,184	F 00V C60 337	11-23-236/1184
1,188	F 00V C60 339	11-23-236/1188
1,192	F 00V C60 341	11-23-236/1192
1,196	F 00V C60 343	11-23-236/1196
1,20	F 00V C60 345	11-23-236/120
1,204	F 00V C60 347	11-23-236/1204
1,208	F 00V C60 349	11-23-236/1208
1,212	F 00V C60 351	11-23-236/1212
1,216	F 00V C60 353	11-23-236/1216
1,22	F 00V C60 355	11-23-236/122
1,224	F 00V C60 357	11-23-236/1224
1,228	F 00V C60 359	11-23-236/1228
1,232	F 00V C60 361	11-23-236/1232
1,236	F 00V C60 363	11-23-236/1236
1,24	F 00V C60 365	11-23-236/124