

BOSCH Common Rail

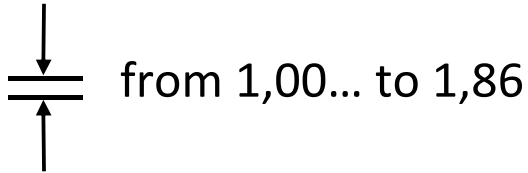

Other measures supplied on demand

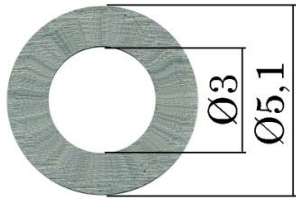
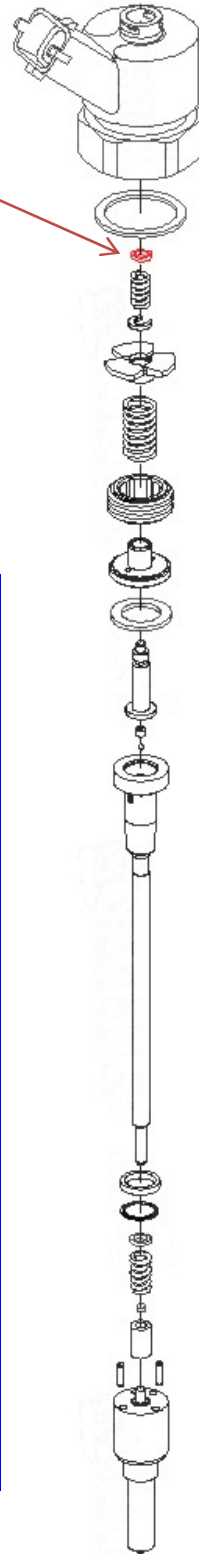

specific shim code	
thickness	code
1,00	11-23-330/100
1,02	11-23-330/102
1,04	11-23-330/104
1,06	11-23-330/106
1,08	11-23-330/108
1,10	11-23-330/110
1,12	11-23-330/112
1,14	11-23-330/114
1,16	11-23-330/116
1,18	11-23-330/118
1,20	11-23-330/120
1,60	11-23-330/160
1,62	11-23-330/162
1,64	11-23-330/164
1,66	11-23-330/166
1,68	11-23-330/168
1,70	11-23-330/170
1,72	11-23-330/172
1,74	11-23-330/174
1,76	11-23-330/176
1,78	11-23-330/178
1,80	11-23-330/180
1,82	11-23-330/182
1,84	11-23-330/184
1,86	11-23-330/186

code	thickness	increase	pcs.
AZ0019-58CR	from 1,60 to 1,86	0,02	140
AZ0019-43CR	from 1,00 to 1,20	0,02	110



24 positions box